

PLOTTED: 6/12/2024

FILE PATH: \\server\Landscape\PROJECTS\JONES AND CARTER\JC02402 - WESTCOTT ROUNDABOUT\10\_WORKING CAD\03\_LAYOUT\JC02402\_LAYOUT\_SPELBLE2.Hwg7.ctb

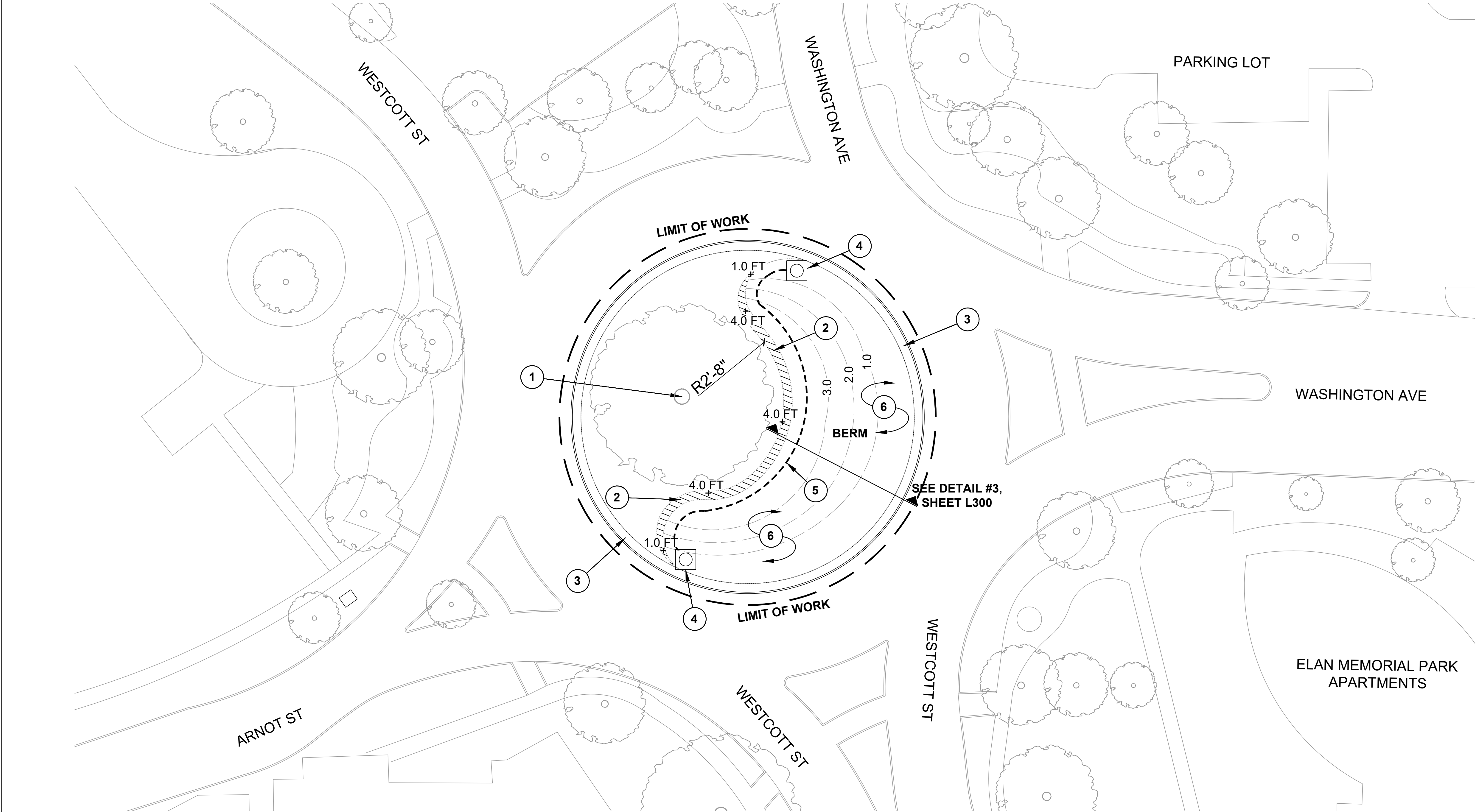

GENERAL NOTES

- CONTRACTOR SHALL BE RESPONSIBLE FOR THE LAYOUT OF ALL PROPOSED LANDSCAPE WALLS AND ELEMENTS. ANY AND ALL SURVEYING COSTS FOR THE PROPOSED HARDSCAPE ELEMENTS SHALL BE THE RESPONSIBILITY OF THE CONTRACTOR.
- THE CLIENT SHALL PROVIDE LIMIT OF WORK SURVEYING OF LANDSCAPE RESERVES, RIGHTS OF WAY, EASEMENTS. THE CONTRACTOR SHALL NOTIFY THE LANDSCAPE ARCHITECT OR OWNER'S REPRESENTATIVE OF ANY LACK OF SURVEYING POINTS, OR DISCREPANCIES PRIOR TO INITIATING CONSTRUCTION.
- THE CONTRACTOR SHALL LAYOUT ALL PROPOSED LANDSCAPE ELEMENTS IN THE FIELD FOR APPROVAL BY LANDSCAPE ARCHITECT OR OWNER'S REPRESENTATIVE PRIOR TO INITIATING CONSTRUCTION.
- CONTRACTOR SHALL BE RESPONSIBLE FOR VERIFYING THE LOCATIONS AND CONDITIONS OF EXISTING UTILITIES.
- CONTRACTOR SHALL LAYOUT ALL LANDSCAPE ELEMENTS SO THAT THEY ARE LOCATED ENTIRELY IN THE LANDSCAPE RESERVES.
- PARKING LOT DIMENSIONS ARE TO BACK OF CURB UNLESS OTHERWISE STATED.

PLAN NOTES

- EXISTING TREE TO BE PRESERVED, **SEE DETAIL #3, SHEET L101.**
- METAL WALL, **SEE DETAIL #4, SHEET L300**
- CONCRETE BAND AT CURB, **SEE DETAIL #2, SHEET L300**
- MITER DRAIN, **SEE DETAIL #1, SHEET L300**
- 4" SCH 40 PERFORATED PIPE, **SEE DETAIL #4, SHEET L300**
- BRING IN ADDITIONAL SOIL NEEDED TO SHAPE BERM AND ADD 1" OF ENRICHED TOPSOIL OVER ENTIRE AREA

PLAN LEGEND

NOTICE:

FOR YOUR SAFETY, YOU ARE REQUIRED BY TEXAS LAW TO CALL 811 AT LEAST 48 HOURS BEFORE YOU DIG SO THAT UNDERGROUND LINES CAN BE MARKED. THIS SIGNATURE DOES NOT FULFILL YOUR OBLIGATION TO CALL 811

VERIFICATION OF PRIVATE UTILITY LINES

Date

CenterPoint Energy natural gas utilities shown. (Gas service lines are not shown). This signature not be used for conflict verification.

Signature valid for six months.

Date

CenterPoint Energy/UNDERGROUND Electrical Facilities Verification ONLY. (This signature verifies existing underground facilities – not to be used for conflict verification)

Signature valid for six months.

Date

Approved for AT&T underground conduit facilities only. Signature valid for one year.



**M2L ASSOCIATES, INC.**  
 8855 KATY FWY, # 300 HOUSTON, TX 77024  
 713-722-8897 • WWW.M2LASSOCIATES.NET  
 Landscape Architecture • Land Planning • Urban Design

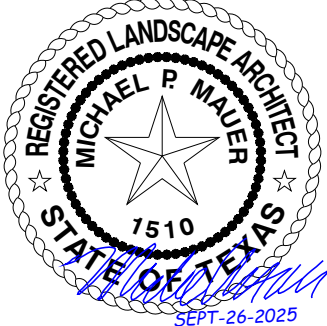

SURVEYED BY: AGS, LLC

FB NO. 000000

CITY OF HOUSTON  
HOUSTON PUBLIC WORKS

WESCOTT  
ROUNDAABOUT  
HARDSCAPE PLAN  
L200

WBS NUMBER	FOR CITY OF HOUSTON USE ONLY
M-430296-0011	
DRAWING SCALE	
AS NOTED	
CITY OF HOUSTON PM	
PARESH LAD, ENV SP	
SHEET NO. of	



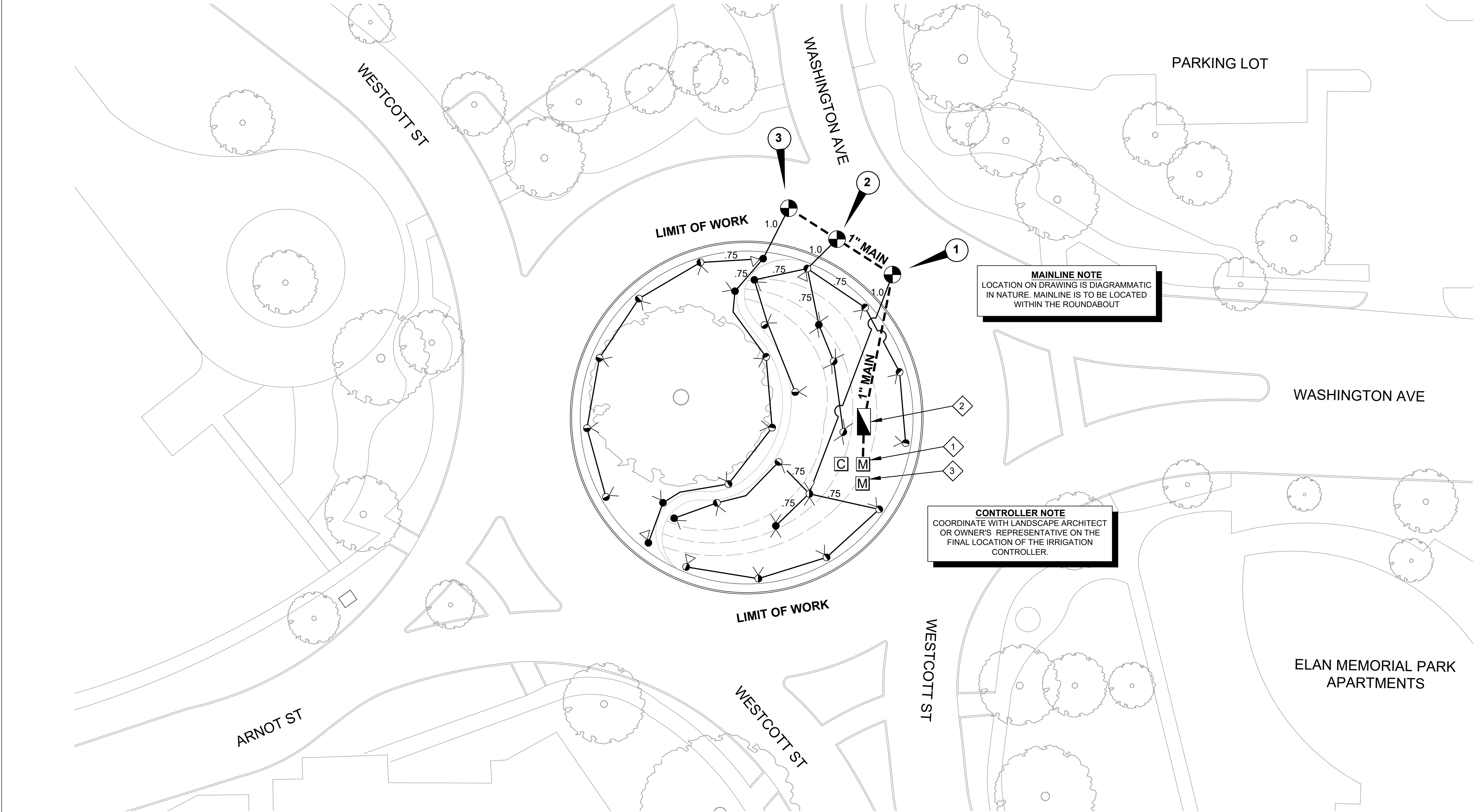

**MAINLINE NOTE**  
 LOCATION ON DRAWING IS DIAGRAMMATIC  
 IN NATURE. MAINLINE IS TO BE LOCATED  
 WITHIN THE ROUNDABOUT

**CONTROLLER NOTE**  
 COORDINATE WITH LANDSCAPE ARCHITECT  
 OR OWNER'S REPRESENTATIVE ON THE  
 FINAL LOCATION OF THE IRRIGATION  
 CONTROLLER.

**NOTICE:**  
 FOR YOUR SAFETY, YOU ARE REQUIRED BY TEXAS LAW TO CALL 811  
 AT LEAST 48 HOURS BEFORE YOU DIG SO THAT UNDERGROUND LINES  
 CAN BE MARKED. THIS SIGNATURE DOES NOT FULFILL YOUR  
 OBLIGATION TO CALL 811

VERIFICATION OF PRIVATE UTILITY LINES

Date  
 CenterPoint Energy natural gas utilities shown. (Gas service lines are not  
 shown). This signature not to be used for conflict verification.  
 Signature valid for six months.

Date  
 CenterPoint Energy/UNDERGROUND Electrical Facilities Verification ONLY.  
 (This signature verifies existing underground facilities – not to be used  
 for conflict verification)  
 Signature valid for six months.

Date  
 Approved for AT&T underground conduit facilities only.  
 Signature valid for one year.

**M2L ASSOCIATES, INC.**  
 8855 KATY FWY, # 300 HOUSTON, TX 77024  
 713-722-8897 • WWW.M2LASSOCIATES.NET  
 Landscape Architecture • Land Planning • Urban Design

SURVEYED BY: AGS, LLC  
 FB NO. 000000

GENERAL NOTES

- A. ALL PIPE LOCATIONS AND IRRIGATION EQUIPMENT ARE SHOWN DIAGRAMMATICALLY. IT IS INTENDED THAT THE EQUIPMENT BE PLACED IN THE LANDSCAPE AREA OR AREAS DESIGNATED FOR SLEEVE AND BORE. CONTRACTOR SHALL MODIFY THE LAYOUT AS NECESSARY TO REFLECT THE ACTUAL SITE CONDITIONS AND PROVIDE HEAD TO HEAD COVERAGE IN ALL AREAS.  
 B. IRRIGATION CONTRACTOR IS TO VERIFY THE CONDITIONS AND LOCATIONS OF ALL EXISTING IRRIGATION EQUIPMENT PRIOR TO BEGINNING CONSTRUCTION.  
 C. CONTRACTOR TO PROVIDE ALL MISCELLANEOUS BORINGS UNDER SIDEWALKS AND PAVEMENT.  
 D. HEADS MARKED WITH AN 'F' ARE FIXED RISER HEADS  
 E. IRRIGATION HEADS TO BE LOCATED 1'-0" FROM B.O.C. UNLESS NOTED OTHERWISE  
 F. CONTRACTOR TO PROVIDE, UNDER THIS CONTRACT, ALL IRRIGATION EQUIPMENT INCLUDING , BUT NOT LIMITED TO, ALL PERMITS AND FEES, BACKFLOW PREVENTERS, METERS, VALVES, HEADS, LATERAL AND MAINLINES, AND MISC. EQUIPMENT.  
 G. **SEE SHEET L501 & L502** FOR IRRIGATION DETAILS AND NOTES.  
 H. IRRIGATION CONTRACTOR TO VERIFY THE CONDITIONS AND LOCATIONS OF ALL EXISTING IRRIGATION EQUIPMENT ALONG ROADWAY PRIOR TO BEGINNING ROADWAY CONSTRUCTION.  
 I. CONTRACTOR SHALL PLACE NEW METER IN THEIR VALVE FOR DURATION OF CONSTRUCTION CONTRACT UP THROUGH SUBSTANTIAL COMPLETION.  
 J. CONTRACTOR SHALL PAY FOR ALL WATER & ASSOCIATED COSTS TO PROVIDE METER.  
 K. KEEP ALL FITTINGS AT LEAST 18" APART.  
 L. COORDINATE ALL INSPECTIONS WITH CITY OF HOUSTON ADOPT-AN-ESPLANADE COORDINATOR.  
 M. CONTRACTOR TO APPLY WATER TO ALL LANDSCAPE AREAS NOT COVERED BY AUTOMATED IRRIGATION FOR DURATION OF CONSTRUCTION AND THROUGH **90 DAY** MAINTENANCE PERIOD.

PLAN NOTES

- 1 EXISTING METER  
 2 NEW BACKFLOW  
 3 ABANDON EXISTING METER

VALVE NO.	DESCRIPTION	VALVE SIZE	ZONE GPM
1	ROTOR	1.0"	15.00
2	ROTOR	1.0"	14.25
3	ROTOR	1.0"	14.25

PLAN LEGEND

- C NEW CONTROLLER  
 NEW BACKFLOW DEVICE  
 M EXISTING WATER METER  
 POINT OF CONNECTION  
 - - - PRESSURE MAINLINE 18" MIN. COVER  
 — LATERAL LINE 12" MIN. COVER

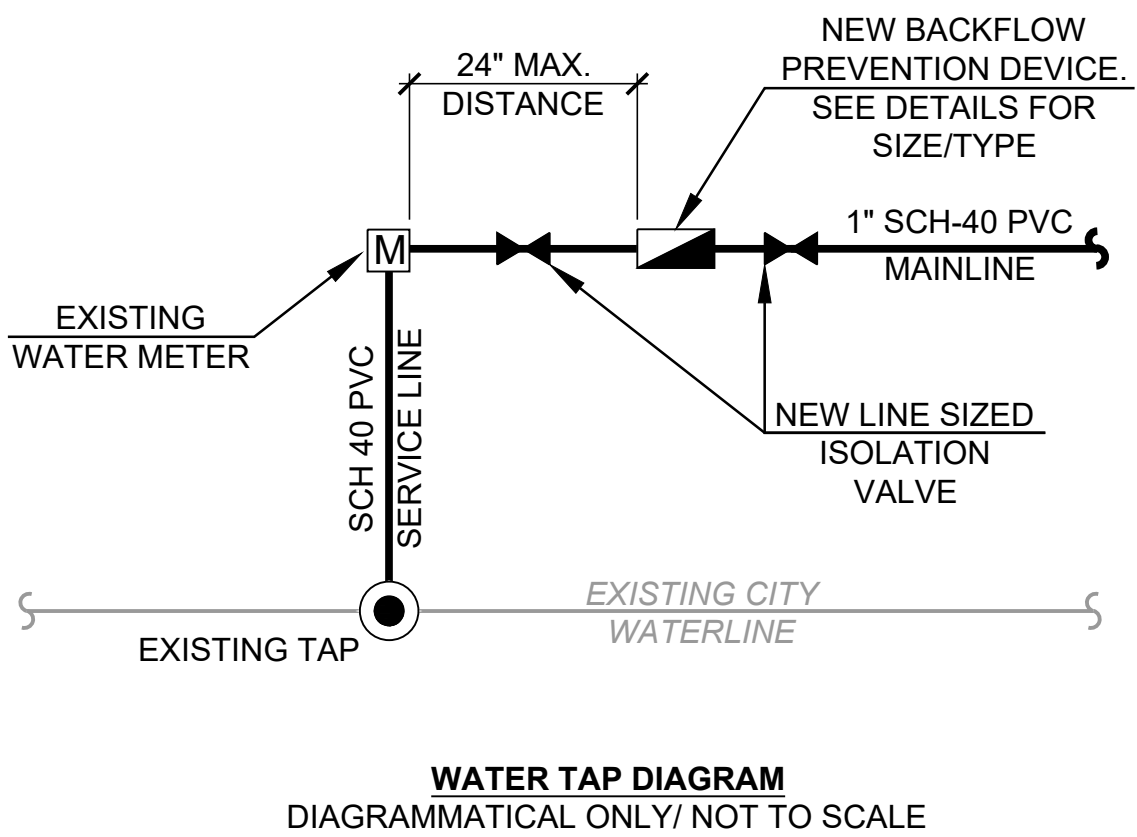

CITY OF HOUSTON  
 HOUSTON PUBLIC WORKS

WESCOTT  
 ROUNDABOUT  
 IRRIGATION LAYOUT  
 L400

WBS NUMBER	FOR CITY OF HOUSTON USE ONLY
M-430296-0011	
DRAWING SCALE	
AS NOTED	
CITY OF HOUSTON PM	
PARESH LAD, ENV SP	
SHEET NO. of	



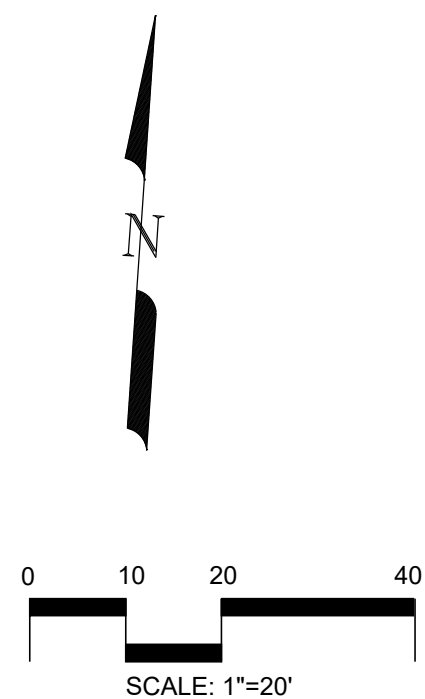

NO.	DATE	REVISION	APP.

FOR YOUR SAFETY, YOU ARE REQUIRED BY TEXAS LAW TO CALL 811  
AT LEAST 48 HOURS BEFORE YOU DIG SO THAT UNDERGROUND LINES  
CAN BE MARKED. THIS SIGNATURE DOES NOT FULFILL YOUR  
OBLIGATION TO CALL 811!

## Date \_\_\_\_\_

CenterPoint Energy natural gas utilities shown. (Gas service lines are not shown). This signature not be used for conflict verification.

Signature valid for six months.

Date \_\_\_\_\_

CenterPoint Energy/UNDERGROUND Electrical Facilities Verification ONLY.  
(This signature verifies existing underground facilities – not to be used  
for conflict verification)

Signature valid for six months

Date

Approved for AT&T underground conduit facilities only.  
Signature valid for one year.



SURVEYED BY: AGS, LLC  
FB NO. 000000



## PLAN LEGEND

- A. CONTRACTOR TO LAYOUT ALL PLANTING BED LIMITS AND LOCATIONS OF ALL PROPOSED TREES IN THE FIELD FOR APPROVAL OF LANDSCAPE ARCHITECT.
- B. TREES SHALL BE PLANTED NO CLOSER THAN 5'-0" (AS MEASURED FROM CENTER OF TRUNK) FROM ANY WALKWAY, FENCE, BUILDING, OR OTHER HARDSCAPE ITEM.
- C. CONTRACTOR SHALL FINE GRADE ALL LANDSCAPE AREAS.
- D. CONTRACTOR TO PROVIDE MINIMUM 1" OF APPROVED TOPSOIL (OR APPROVED ON-SITE, AMENDED TOP SOIL STRIPPINGS) WORKED INTO EXISTING SOIL FOR ALL AREAS TO RECEIVE HYDROMULCHING AND SOLID SOD.
- E. WHERE INDICATED ON THE DRAWINGS AS TURF, THIS SHALL MEAN FULL COVERAGE HYDROMULCHING PER SPECIFICATIONS. WHERE INDICATED ON THE DRAWINGS AS SOD, THIS SHALL MEAN SOLID SOD COVERAGE PER SPECIFICATIONS.
- F. CONTRACTOR TO PROVIDE METAL PLANTING BED EDGING FOR ALL AREAS WHERE TURF AREAS ADJOIN PLANTING BEDS.
- G. CONTRACTOR SHALL BE RESPONSIBLE FOR PROVIDING TURF TO ALL AREAS DAMAGED FROM CONSTRUCTION RELATED ACTIVITIES BEYOND THOSE INDICATED ON THE PLANTING AND/OR CIVIL ENGINEERING PLANS AT NO ADDITIONAL COST TO THE OWNER.

1. EXISTING TREE TO BE PRESERVED - TYPICAL
2. 4" THICK MULCH RING AT EXISTING TREE, **SEE DETAIL #2, SHEET L101**
3. SOLID SOD
4. SHOVELED EDGE, **SEE DETAIL #1, SHEET L101.**

<div style="text-align: center;"> <h1>CITY OF HOUSTON</h1> <h2>HOUSTON PUBLIC WORKS</h2> <h1>WESCOTT ROUNDBOUT</h1> <h2>PLANTING PLAN</h2> <h3>L600</h3> </div>	
WBS NUMBER	FOR CITY OF HOUSTON USE ONLY
M-430296-0011	
DRAWING SCALE	
AS NOTED	
CITY OF HOUSTON PM	
PARESH LAD, ENV SP	
SHEET NO. of	